

PHASE 2 - RAMP A CONSTRUCTION:  
 REMOVE TEMPORARY SOUTHBOUND OFF RAMP PAVEMENT.  
 EXISTING SOUTHBOUND ON RAMP ACCESS TO REMAIN OPEN THROUGH STAGED CONSTRUCTION OF RAMP A.

STAGE 3:  
 SHIFT SOUTHBOUND ON RAMP TRAFFIC TO NEWLY CONSTRUCTED PORTION OF RAMP A PAVEMENT.  
 REMOVE TEMPORARY SOUTHBOUND ON RAMP PAVEMENT.  
 UPON COMPLETION OF RAMP A, OPEN SOUTHBOUND I-44 TRAFFIC TO NORMAL OPERATION.



OKLAHOMA DEPARTMENT OF TRANSPORTATION					
FED. ROAD DIST. NO.	STATE	JOB PIECE NO.	FISCAL YEAR	SHEET NO.	TOTAL SHEETS
6	OKLA.	27050(04)	2017		
DESCRIPTION		REVISIONS		DATE	

- NOTE:
- CONSTRUCTION SIGNS SHALL BE VISIBLE ONLY WHEN ACTIVITIES WARRANT. TO BE COVERED OR REMOVED WHEN NOT IN USE.
  - EXISTING SIGNS THAT WOULD INTERFERE WITH CONSTRUCTION ZONE SIGNING SHALL BE REMOVED OR COVERED.
  - ANY EXISTING CONFLICTING STRIPING SHALL BE REMOVED PRIOR TO SHIFTING TRAFFIC.
  - DIRECTIVES FROM STANDARD PDT-1 "PAVEMENT DROP-OFF TREATMENTS" SHALL BE FOLLOWED AT ALL TIMES.
  - (1) W1-8 SHALL BE PLACED ON EVERY OTHER DRUM THRU LANE TAPERS. (1) R4-7A(R) OR (1) R4-7A(L) (AS APPLIES) SHALL BE PLACED ON EVERY OTHER DRUM THRU TANGENT LANES.
  - THE ENDS OF THE PORTABLE CONCRETE MEDIAN BARRIER MUST EITHER BE FLARED TO OUTSIDE OF CLEAR ZONE (PER AASHTO ROADSIDE DESIGN GUIDE LATEST EDITION) OR PROTECTED BY A ODOT APPROVED ATTENUATOR AT ALL TIMES.
  - GUIDELINES FROM THE 2009 MUTCD SHALL GOVERN.

LEGEND	
	DRUM
	CONSTRUCTION SIGN
	TYPE III BARRICADE
	UNDER CONSTRUCTION
	COMPLETED CONSTRUCTION
	DIRECTION OF TRAFFIC ARROW
	PORT. CONCRETE MEDIAN BARRIER (P.C.M.B.)
	TEMP. IMPACT ATTENUATOR
	ARROW BOARD

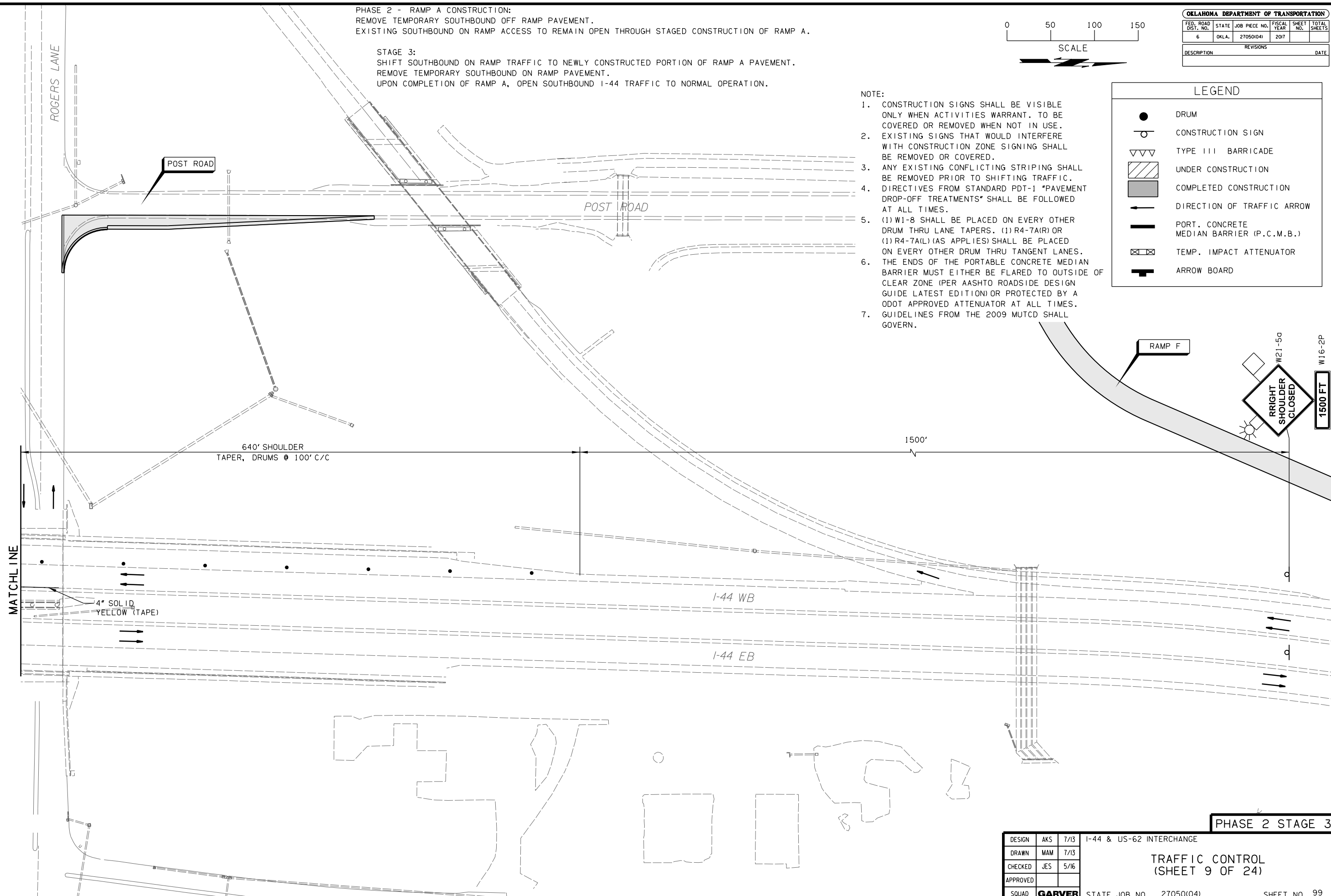

PHASE 2 STAGE 3

DESIGN	AKS	7/13	I-44 & US-62 INTERCHANGE
DRAWN	MAM	7/13	
CHECKED	JES	5/16	
APPROVED			
SQUAD	<b>GARVER</b>		

TRAFFIC CONTROL  
(SHEET 9 OF 24)

STATE JOB NO. 27050(04) SHEET NO. 99